

# Acoustic Door Threshold

## 1. Measure

Measure the door sill (frame width at bottom) and cut the threshold to extend the full width of the opening.

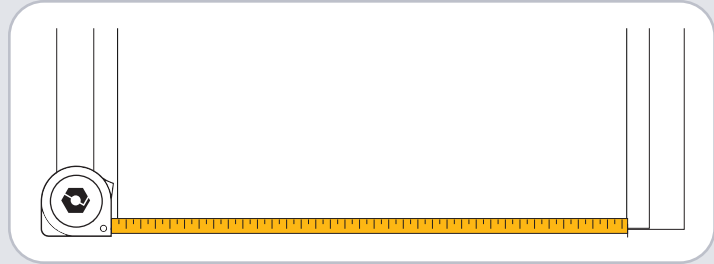

## 2. Cut

Notch the threshold sides if necessary to accommodate the side jamb stops. Shim the saddle if needed and make sure that it is completely level.

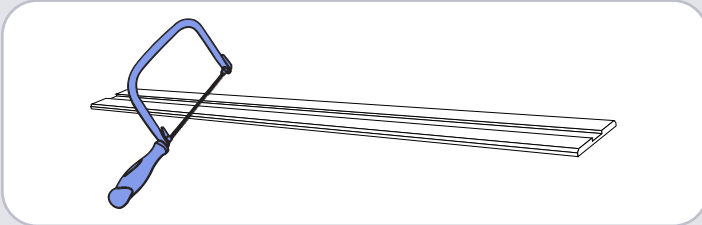
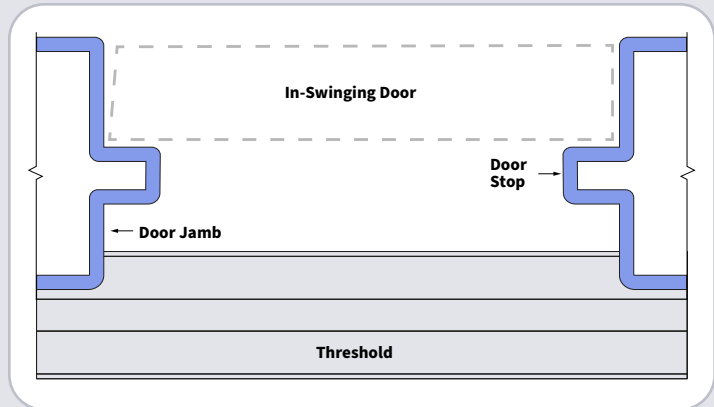

## 3. Secure

Fasten the threshold to the sill with screws provided.

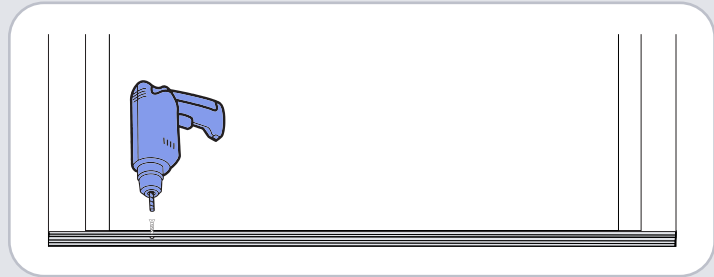

## 4. Examine

Operate the door several times to ensure the part is properly adjusted so as not to inhibit the door from self-closing and latching.

## 5. Caulk

Caulk around base of saddle for increased moisture control.

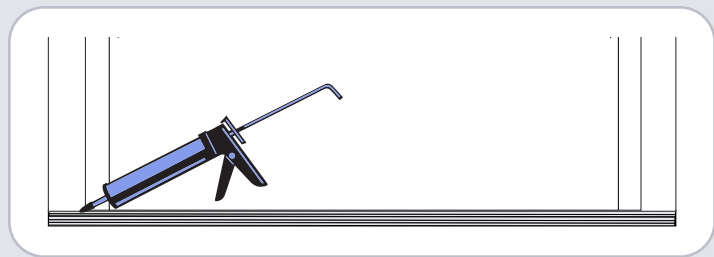

Revised: 2025-04-30