



# PrivacyShield® Soundproof Door

## Installation Kit

### Step 3

Door install kit contains the following: shims, backer rod, heavy duty screws, strike plate screws, acoustical sealant, door handles, jamb seals and installation instructions.

2A



Revised: 2025-04-30

# PrivacyShield® Soundproof Door

## Installation

### Step 1

Remove (4) screws and the temporary bottom plate, located at bottom of the door.



### Step 2

Verify door swing and stand door against wall on appropriate side. Verify rough opening width and height.

#### **VERY IMPORTANT (Floor Preparation):**

Ensure that the floor under the door slab is flat and level. You may install a flat, level and smooth threshold. If the existing floor is not flat, level and smooth-the bottom door seal will not perform properly. **DO NOT** raise the hinge side of the jamb off of the floor. The factory undercut of the door is set to the proper height.



### Step 3

Cut bands that hold door together. Move door into rough opening by walking the door from left to right in small steps. Install door until back side of door trim is tight against face of wall.

Revised: 2025-04-30

# PrivacyShield® Soundproof Door

## Marking for the Hinges

### Step 4

**A** Measure from top of door to center of each hinge and record the distances.

**B** Transpose the measurements on opposite side of door and mark locations.

**C** Install shims directly behind hinges at these locations and tack into place with pin nails.



Revised: 2025-04-30

# PrivacyShield® Soundproof Door

## Installing the Hinges

### Step 5

Remove (2) screws per hinge closest to door stop. Pre-drill and install heavy duty hinge screws provided into the two hinge holes as shown. It is very important to make sure this side of the door is plumb, adjusting with shims as necessary as you move from hinge to hinge. If the screws do not contact solid wood for required holding power, it may be necessary to remove the door seal and install screws beneath the seal on the doorstop and reinstall it.



**INSTALL TIP: IF SEAL REMOVAL IS NEEDED TO MAKE CONTACT INTO SOLID WOOD FRAMING**

1. To remove the door seal, remove the screws going through the seal into the wood doorstops.
2. Install long screws through the wood doorstops. Be sure to countersink the long screws so that the door seals rest flat on the wood doorstop.
3. Reinstall the door seal with the screws previously removed from the seal.

Revised: 2025-04-30

# PrivacyShield® Soundproof Door

## Aligning the Jamb

### Step 6

**A** Shim the reveal on latch side of door between the door and jamb to  $\frac{1}{8}$ "

**B** Scribe a horizontal line from center of latch in door to centerline of door strike respectively

**C** Raise or lower the jamb to align. Install shims and nail or screw into jamb

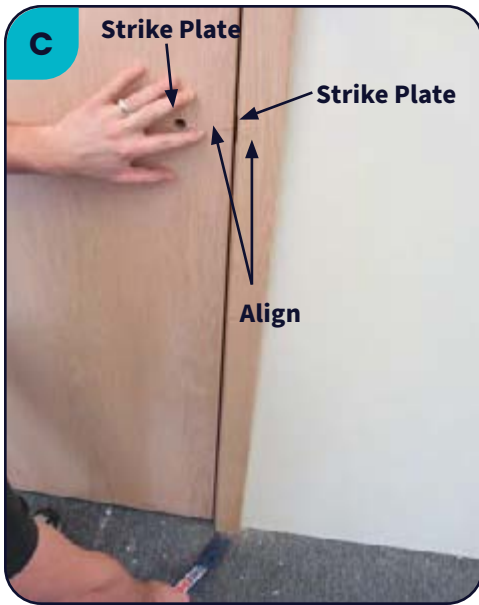

Revised: 2025-04-30

# PrivacyShield® Soundproof Door

## Installing the Strike

### Step 7

Replace strike side hardware with long screws provided. If the screws do not contact solid wood for required holding power, it may be necessary to remove the door seal and install screws beneath the seal to install the strike. (Refer to install tip in step 5.)



Revised: 2025-04-30

# PrivacyShield® Soundproof Door

## Optional Extension Jamb Installation

### Step 1

- A** Measure distance from standard door jamb to edge of finished wall
- B** Cut down extension jamb kit accordingly, remembering not to measure from the top of the tongue, but rather from the base as the tongue is inserted into the standard door jamb

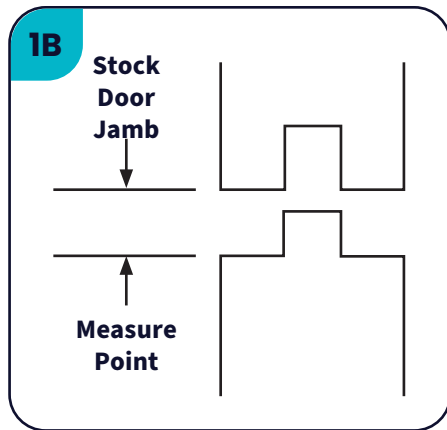

### Step 2

- Install wood glue into the groove of the standard door frame. Insert extension jamb and nail into place



### Step 3

- Install wood putty at joint and sand until smooth



Revised: 2025-04-30

# PrivacyShield® Soundproof Door

## Installing the Seal

### Step 1

Remove excess shim with a wood chisel



### Step 2

**A** Install sealant backer rod into space between door jamb and rough opening a minimum of 1" deep

**B** Squeeze in acoustical sealant



Revised: 2025-04-30

# PrivacyShield® Soundproof Door

## Installing the Trim

### Step 1

Remove temporary support from bottom of pre-assembled trim casing. Center on door opening and pin nail into place to hold



### Step 2

Fasten to jamb with trim screws provided



### Step 3

Nail trim to wall as needed



Revised: 2025-04-30

# PrivacyShield® Soundproof Door

## Installing the Sound Seal

### Step 1

Remove trim from slab side of door



### Step 2

**A** Install sealant backer rod into space between door jamb and rough opening a minimum of 1" deep

**B** Squeeze in acoustical sealant



Revised: 2025-04-30

# PrivacyShield® Soundproof Door

## Installing the Sound Seal

### Step 3

Nail trim to wall as needed

### Step 4

Fill holes with wood putty and sand



Revised: 2025-04-30

# PrivacyShield® Soundproof Door

## Installing the Handle Set

### Step 1

Install handleset per included instructions

#### INSTALL TIP:

GU Hardware is a universal hardware system which can be used for a right or left handed door. If you have selected the GU Hardware system, please refer to the installation instructions to change handing of door hardware.

#### Venice — Passage Only



#### Venice — Thumb Turn Deadbolt



#### Venice — Keyed Deadbolt



Revised: 2025-04-30

# PrivacyShield® Soundproof Door

## Installing Door Jamb Seals

### Step 1

Begin by installing the secondary seal on the latch jamb side of the door. Rough cut a length of seal approximately 2" longer than needed to run the entire distance from the top to the top of the door to the floor. Starting at the top of the door jamb remove about 18" or so of the protective facing from the self-stick adhesive and butt the end of the seal against the top of door jamb. While aligning the flat edge of the seal with the back edge of the strike plate opening (see photo-1). Remove more protective facing while you work your way down keeping the seal parallel with the remaining two strike plates and permanently attach the seal to the door jamb. Trim flush at the bottom.

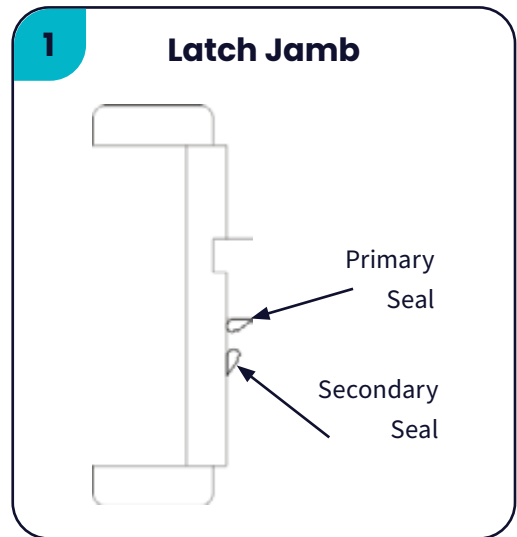
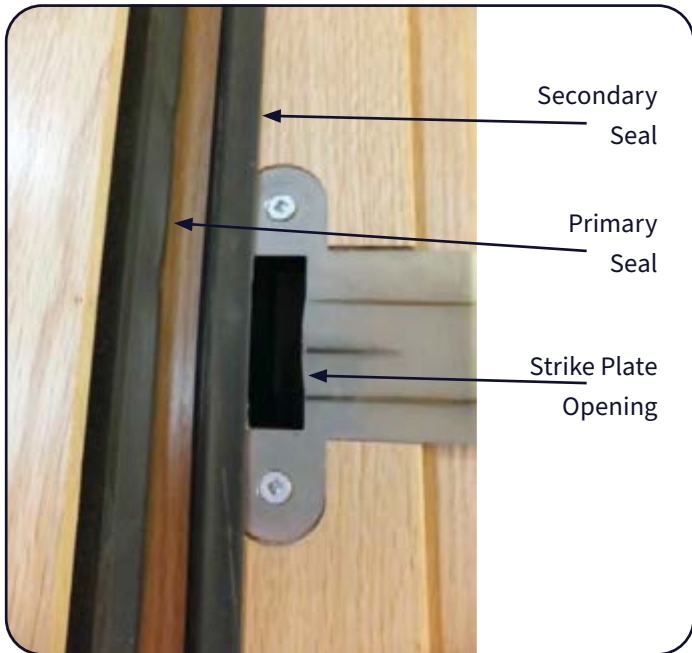

Revised: 2025-04-30

# PrivacyShield® Soundproof Door

## Installing Door Jamb Seals

### Step 2

Next, install the secondary seal at the top of door jamb as described previously by first butting the seal into the latch jamb seal. Align parallel with the door jamb and trim flush with the hinge jamb.

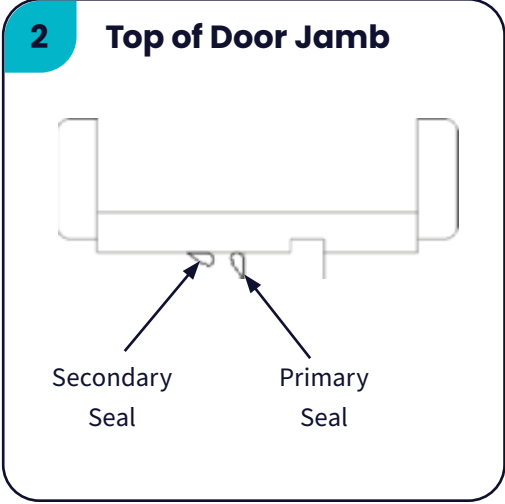

### Step 3

Repeat this process by butting hinge jamb seal into the top of door jamb and working your way down and trimming flush at the bottom.

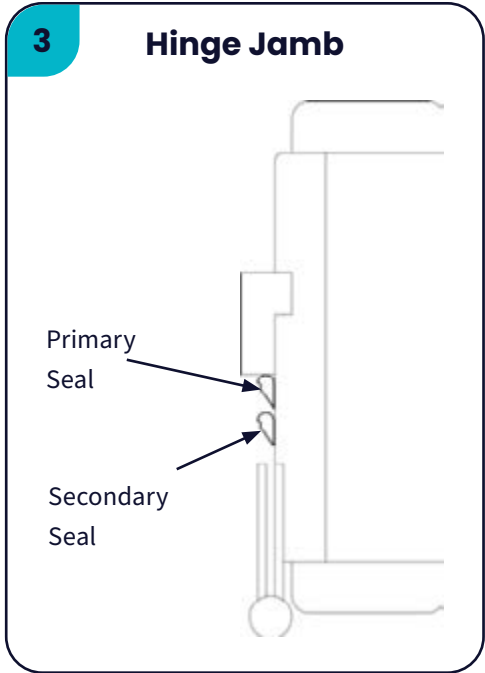

### Primary Seal Installation:

The primary seal is to be installed in the same order as the secondary seal (latch jamb, top of door jamb, hinge jamb).

Note that the latch jamb and top of door jamb seals are to attach to the door stop as shown in fig. 1 & 2 and the hinge jamb seal is to attach to the hinge jamb as shown in fig. 3.

Revised: 2025-04-30

# PrivacyShield® Soundproof Door

## Adjusting the Seals

### Step 1

With door installed and latched, use a Phillips head screw driver and turn to adjust compression of neoprene seal against door. Keep compression moderate and do not over tighten. If seals are adjusted to tightly against door it will make closing and latching the door difficult.



### Step 2

Bottom drop seal comes factory set at its up most position. With a Phillips screw driver, gradually turn out screw in steps 90° or less at a time to increase seal pressure against floor. Watch as door closes and seal activates and contacts floor. Do not over increase pressure or damage to the seal may result.

#### **VERY IMPORTANT (Floor Preparation):**

Ensure that the floor under the door slab is flat and level. You may install a flat, level and smooth threshold if the existing floor is not flat, level and smooth. The bottom door seal will not perform properly. **DO NOT** raise the hinge side of the jamb off of the floor. The factory undercut of the door is set to the proper height.



Revised: 2025-04-30

# PrivacyShield® Soundproof Door

## Adjusting the Seals

### Step 3

Install wood door seal covers. Peel backing from double sided tape. Install the top cover first. Applying pressure to areas with tape. Next install both sides.

**INSTALL TIP:** You may brad nail the wood seal covers into the wood door stop for permanent installation. Be sure to hit the wood stop with the brad nail.

**INSTALL TIP:** If you are unsure that you have adjusted the jamb seals correctly, adjust the bottom seal before installing the jamb seal covers.

**IMPORTANT:** Once you have put jamb seal covers on, they are not meant to be removed for additional adjustments.

### Step 4

Fill all nail and screw holes with the wood putty (not included).



**Your install is now complete and ready for stain or paint finishing.**

Revised: 2025-04-30